

Tools Required

Safety glasses
Flathead screwdriver
3/8 wrench

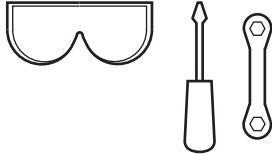

Breakdown Steps

1. Turn the chair on its back to reveal the softique material covering the base of the unit. Locate the zipper that allows access to the assembly screws. (Figure A1).

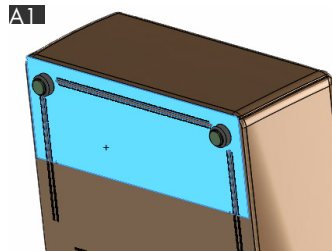

3. Using a 3/8 wrench or socket wrench remove all 4 screws from the frame. This will release the seat from the back.

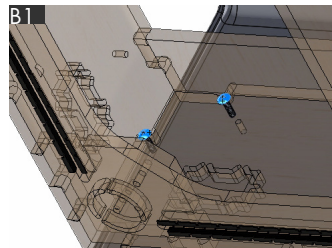

3. To remove the plastic glides Use a flat head screw driver to pry the insert from the glide. This will reveal a screw fastening the glide to the unit. Unscrew this to release the glide from the unit.



4. If the units have ganging brackets you can remove them as well. Locate the knob fastening the bracket to the unit. Turn the knob counter clockwise to release the bracket.

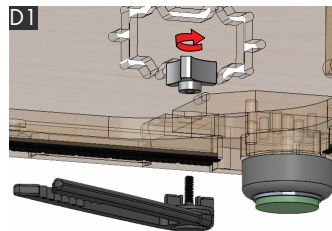

- Back cushion
- Material:
Foam, plywood, upholstery

- Ganging bracket
- Material:
Nylon Plastic

- Assembly Screw
- Material:
Stainless steel

- Bracket turn knob
- Material:
Nylon Plastic

- Glide/Insert
- Material:
Nylon Plastic/Felt

- Slide Channel
- Material:
Polypropylene Plastic

- Seat cushion
- Material:
Foam, plywood, upholstery

